

Honeywell

Dehumidifier User Manual

Read and save these instructions before use

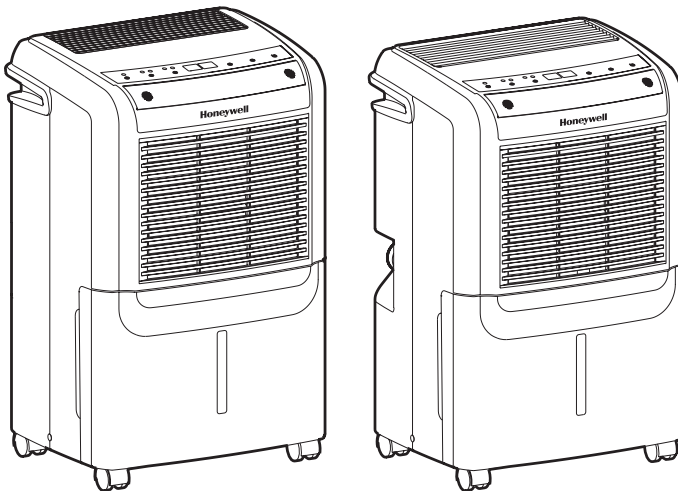

Model:

DH45W/ DH45WGN/
DH45WKN/ DH45PWKN /
DH45PWGN/DH50W/
DH50PW / DH70W /
DH70PW/ DH70WKN/
DH70WGN/DH70PWKN/
DH70PWGN/

Thank you for purchasing a Honeywell Dehumidifier. This User Manual is intended to provide you with important information needed to set up, operate, maintain and troubleshoot this product.

SAFETY RULES

WARNING -- READ AND SAVE THESE INSTRUCTIONS BEFORE USING THIS PRODUCT.

The user of electrical products may create hazards that include, but are not limited to injury, fire, electrical shock. Failure to follow these instructions may damage and/ or impair its operation and void the warranty. In case there is any inconsistency or conflict between the English version and any other language version of the content of this material, the English version shall prevail.

When using electrical appliances, basic safety precautions should always be followed:

- DO NOT touch the dehumidifier or the electrical plug with wet hands.
- Check the household voltage to ensure it matches the appliance's specification.
- Before operating, remove all packaging material and check for any damage that may have occurred during shipping.
- DO NOT operate any product with a damaged cord or plug.
- DO NOT use an extension cord with this appliance.
- DO NOT run power cord under carpeting, or cover it with rugs or runners. Keep the cord away from areas where it may be tripped over.
- Always unplug the dehumidifier before emptying the water tank.
- The water collected in the tank must be discarded. The water should never be used for drinking.
- Always unplug the dehumidifier and remove the water from the water tank before cleaning, servicing or relocating the unit.
- Remove the power cord from the electrical receptacle by grasping and pulling on the power cord plug-end only, never pull the cord.
- This appliance has been manufactured for use in domestic environments and must not be used for other purposes.
- DO NOT use the product in areas where gasoline, paint or other flammable goods and objects are used or stored.
- This dehumidifier is designed for indoor residential applications only. It should not be used for commercial or industrial applications.
- DO NOT attempt to repair or adjust any electrical or mechanical functions of the dehumidifier, as this may cause danger and void the warranty.
- DO NOT cover the air inlet or outlet on the appliance as this may cause the unit to fail.
- DO NOT insert or allow objects to enter any ventilation or exhaust opening as this may damage the product and could cause electrical shock or fire.

SAFETY RULES (CONTINUED)

- DO NOT let children play with this appliance, packaging or included plastic bag.
- If the unit is damaged or it malfunctions, do not continue to operate it. Unplug the product from the electrical outlet. Refer to the troubleshooting section and contact the customer support center.
- Always place the dehumidifier on a leveled floor.
- Never install the product near a bathtub or any water container.
- Store in a dry area, away from direct sunlight, when not in use.
- This appliance and its packaging materials are not intended for use by persons (including children or elderly) with reduced physical, sensory or mental capabilities, or lack of experience and knowledge, unless they have been given supervision or instructions concerning the use of the appliance by a person responsible for their safety.
- Always grip the side handles and keep the unit upright when transporting from room to room – DO NOT tilt the product on its side or upside-down.
- If the dehumidifier was transported tilted on its side, you must position it upright again and wait at least 4 hours before using it.
- **WARNING:** To reduce the risk of fire or electric shock, do not use this appliance with any solid state speed control device.

HOW A DEHUMIDIFIER WORKS

When the dehumidifier is switched ON, a fan pulls moisture-laden air into the dehumidifier where it passes through dehumidifying coils inside the unit. These coils condense moisture from the air and collect it in the water tank. The dry air is then exhausted from the dehumidifier. The air flows through the air vents of the dehumidifier into the room as dry, warm air.

IMPORTANT: The dehumidifier is designed to operate between 41°F (5°C) and 89°F (32°C). The dehumidifier's performance may be greatly reduced if room temperatures exceed this temperature range.

SELECTING A LOCATION - IMPORTANT

- Before using the dehumidifier, place the unit UPRIGHT for at least 1 hour before use to allow the refrigerant to stabilize. If the unit was tilted on its side or upside-down during transportation, set the unit upright for 4 hours before use.
- For optimal efficiency, the dehumidifier must be operated in an enclosed area. Keep all doors, windows and other outside entrances to the room closed.

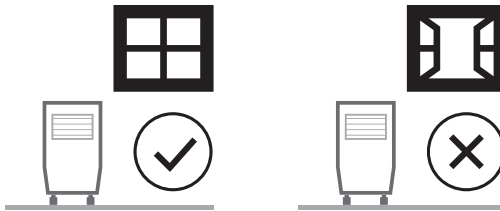

- Place the dehumidifier at least 12 inches (31cm) away from other objects (e.g. curtains or furniture) that may restrict airflow from the front or through the air vents of the unit.
- The dehumidifier must be positioned on a level floor.

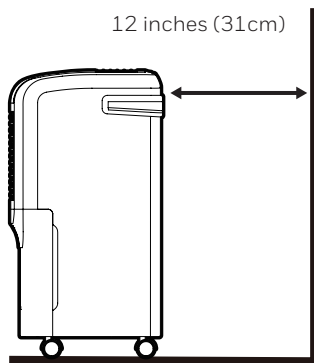

SELECTING A LOCATION - IMPORTANT (CONTINUED)

IMPORTANT: The effectiveness of the dehumidifier can be influenced by different factors. One factor is the rate at which new, moisture-laden air enters the room and the amount of air circulating in and out of the area to be dehumidified. For example, if a door to a basement is constantly opened, letting new, moisture-laden air into the room, dehumidification will take longer than if the door was kept closed. If the dehumidifier is in a room with a storage closet or cabinets, it will have little or no effect in drying the inside of the storage closet or cabinets unless there is adequate circulation of air in and out of these spaces. To dehumidify these spaces, open the storage door or cabinet doors to allow air circulation. You may find that installing a second dehumidifier may be required for larger enclosed areas.

UNPACKAGING THE DEHUMIDIFIER

This Dehumidifier is packaged with a colored or transparent tape to secure some parts during transportation.

Remove all the colored or transparent packaging tape from the unit.

Remove this packaging tape before use. If you do not remove it, the Dehumidifier will not switch ON and a blinking red light will appear.

There is a Float (without polyfoam) located inside the water tank. This works to sense the level of the water inside the tank.

DO NOT REMOVE THIS FLOAT.

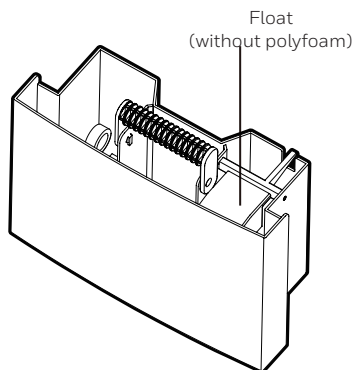

PARTS DESCRIPTION

Model: DH45W

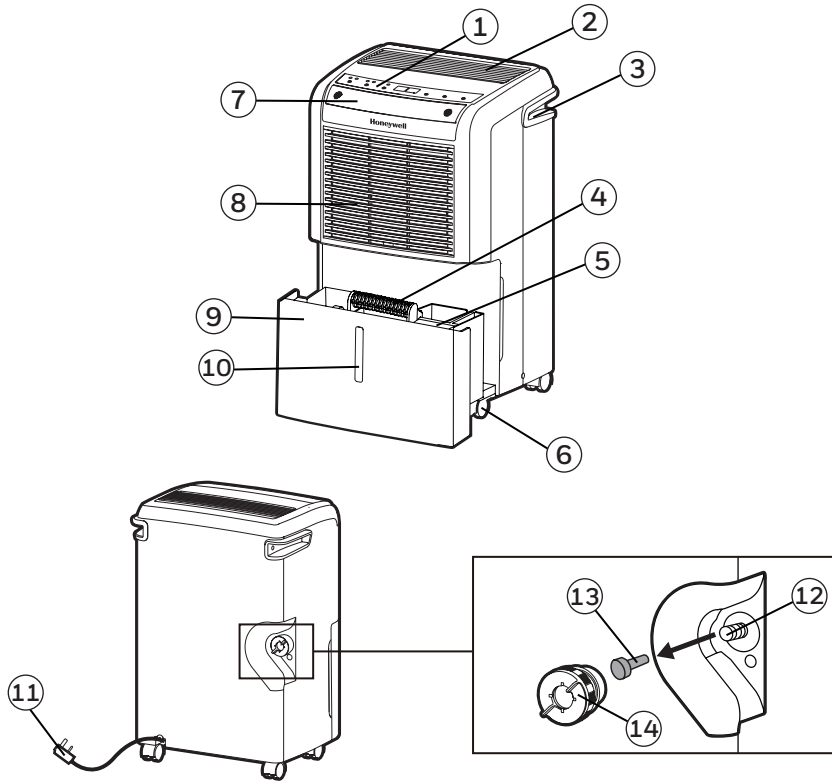

- | | |
|----------------------------------|---------------------------|
| 1) Control Panel | 8) Louvers |
| 2) Dehumidified Air Exhaust Vent | 9) Water Tank |
| 3) Handle | 10) Water Level Indicator |
| 4) Water Tank Handle | 11) Power Cord & Plug |
| 5) Float (without polyfoam) | 12) Direct Drain Outlet |
| 6) Casters | 13) Rubber Stopper |
| 7) Washable Dust Filter | 14) Drain Cap |

PARTS DESCRIPTION (CONTINUED)

Model: DH45WGN / DH45WKN / DH45PWKN / DH45PWGN / DH50W / DH50PW / DH70W / DH70PW / DH70WKN / DH70WGN / DH70PWKN / DH70PWGN

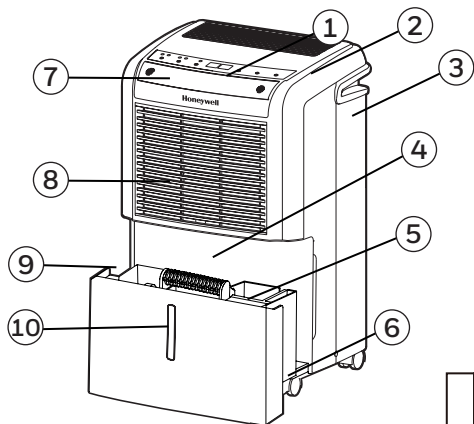

DH45WGN / DH45WKN / DH50W / DH70W / DH70WKN / DH70WGN

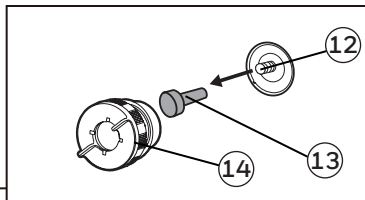

MODELS WITH BUILT-IN DRAIN PUMP:

DH45PWKN / DH45PWGN / DH50PW / DH70PW / DH70PWKN / DH70PWGN

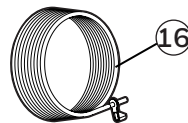
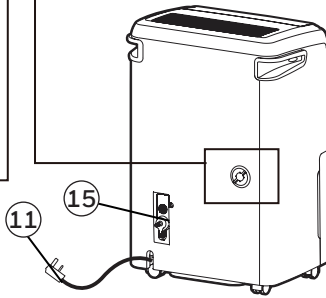
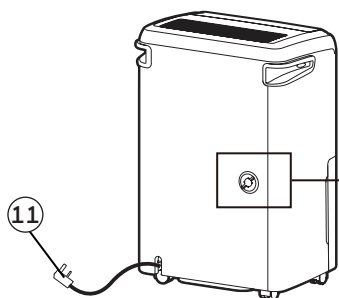

- | | |
|----------------------------------|---------------------------|
| 1) Control Panel | 8) Louvers |
| 2) Dehumidified Air Exhaust Vent | 9) Water Tank |
| 3) Handle | 10) Water Level Indicator |
| 4) Water Tank Handle | 11) Power Cord & Plug |
| 5) Float (without polyfoam) | 12) Direct Drain Outlet |
| 6) Casters | 13) Rubber Stopper |
| 7) Washable Dust Filter | 14) Drain Cap |

THIS IS ONLY FOR MODELS WITH BUILT-IN DRAIN PUMP

- | | |
|---------------------------|----------------|
| 15) Continuous Drain Pump | 16) Drain Tube |
|---------------------------|----------------|

CONTROL PANEL

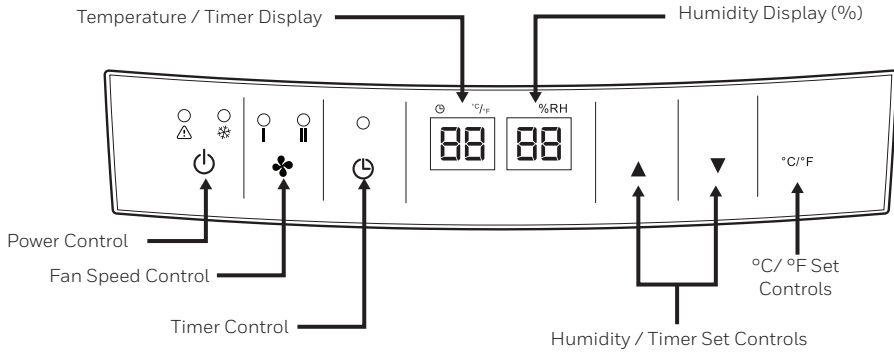

Power Control

Press  to switch the dehumidifier ON or OFF.

Water Tank Full Indicator Light

This illuminates when the Water Tank is full of water or if the Water Tank is not positioned properly on the unit. To switch off , empty the Water Tank and check that the tank is secured properly into place.

Defrost Light

This indicates that the room temperature is too low. Increase the room temperature or wait until the temperature increases to switch off  and to turn the dehumidifier on again.

Fan Speed Control

Press to set the desired fan speed.

There are 2 fan speeds to select from: **High II / Low I**

A higher fan speed results in faster moisture removal.

CONTROL PANEL (CONTINUED)

Timer Control

The dehumidifier can be set to automatically switch ON or OFF after a selected period of time (between 1-24 hour intervals). The Timer hours selection is displayed on the Timer/Temperature Display Screen.

NOTE: Before setting the Timer control, make sure there is power to the unit.

Auto-Off Timer:

While the unit is running, first press  and then tap or hold the ▲ or ▼ to select the number of hours you want the unit to run before it switches off. The unit automatically switches off after the set time period has elapsed. You must repeat the Timer set up procedures to reset the Timer for next use, if needed.

Auto-On Timer:

When unit is in standby mode,  press and ▲ or ▼ to select the number of hours until you want the unit to automatically start running. The previous fan speed and humidity setting will be maintained. The unit will continue running until the water tank is full (unless the unit is set up for continuous draining) or until you switch it off manually.

NOTE: To cancel any Timer settings, simply press  and then tap or hold the ▲ or ▼ until the Timer display shows '0'.

CONTROL PANEL (CONTINUED)

Temperature / Timer Display

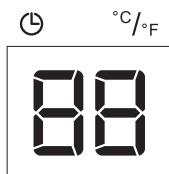

When the unit is switched ON, the Temperature / Timer Display shows the current room temperature. Pressing the Timer ⌚ temporarily switches the display to show the Timer setting (in hours) for 10 seconds, before reverting back to the temperature display.

Humidity Control Setting

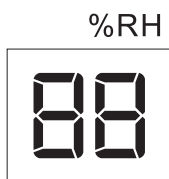

When the unit is switched ON, the Humidity Display shows the current humidity percentage. Press ▲ or ▼ to select your preferred humidity level. The humidity is adjusted in increments of 5% by pressing ▲ or ▼. The adjustable Relative Humidity (RH) range is between 30% RH to 90% RH. Ten seconds after setting the preferred humidity setting, the display will revert back to displaying the current humidity.

Recommended Settings: It is recommended to leave the unit running at 30% humidity at High Fan Speed during the first 2 to 3 days until damp odors are removed. After a few days when the Relative Humidity has been reduced to a more comfortable level, press ▲ or ▼ to choose a higher RH% that maintains a comfortable humidity level thereafter. A recommended healthy humidity level is between 40% and 50%.

NOTE: The humidity sensor senses current humidity in the surrounding area. It is normal for a 5°F to 9°F (3°C to 5°C) variance in the humidity sensitivity from the sensor.

°C/ °F Display Options

Press °C/ °F to change the Temperature Display from degrees Celcius °C to degrees Fahrenheit °F.

DRAINING THE WATER



WARNING: Always drain and discard water collected from dehumidification. The water is not clean and cannot be used for drinking.

1. Draining water collected in the Water Tank

The condensed water can be collected directly into the water tank. When the water tank is full, the dehumidifier will automatically shut OFF and  will illuminate on the control panel followed by a beeping sound.

IMPORTANT: Do not move the dehumidifier when the water tank is full as it will be heavy and can cause water spillage.

1.1 Locate the water tank at the front of the dehumidifier. Gently pull the water tank out and place it on the floor. Two stands located at the bottom of the water tank will automatically extend to help balance the tank on the floor.

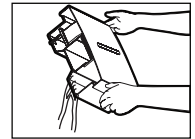
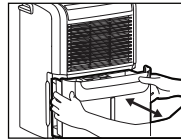

Water Tank Handle

1.2 Grip the handle inside the water tank and carry the water tank to a sink to empty.

1.3 Replace the empty water tank back into the front of the dehumidifier. Please make sure that the tank is properly positioned. The safety feature ensures that any misalignment of the tank and the unit will prevent the unit from turning back on.

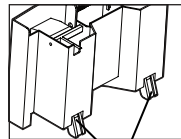

Stands*

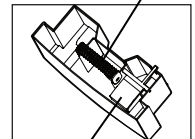

Float
(without polyfoam)

IMPORTANT: Improper alignment or positioning of the water tank will cause the unit to pause operation, the warning light on top of the dehumidifier will illuminate followed by a beeping sound, until the water tank is fitted properly.

NOTE: There is a Float (without polyfoam) inside the water tank that senses the water level to automatically stop dehumidification when the water tank is full. Make sure the Float is positioned correctly inside the water tank by ensuring it lies level with the top edge of the water tank.

*Applicable for models DH45WGN / DH45WKN / DH45PWKN / DH45PWGN / DH50W / DH50PW / DH70W / DH70PW / DH70WKN / DH70WGN / DH70PWKN / DH70PWGN

DRAINING THE WATER (CONTINUED)

2. Continuous Water Drainage – Using a Standard Garden Hose (Garden Hose not included)

For continuous water drainage with a standard garden hose, you will need a garden hose and a suitable water drain (e.g. a sink or drain hole at floor level) near the dehumidifier.

- 2.1 Locate the drain outlet on the back of the unit.
- 2.2 Unscrew and remove both drain cap and rubber stopper.
- 2.3 Locate the female connector at one end of the garden hose. Insert the garden hose onto the drain outlet of the dehumidifier. Screw and tighten the garden hose connector onto the threaded part of the drain outlet, making sure the hose connector is secured to ensure there will be no leaks. If there are leaks, the hose and the drain outlet may not be connected properly. Disconnect, replace and tighten the garden hose connector again.
- 2.4 Position the other end of the garden hose in the sink or drain. Make sure the hose is not bent or kinked which might stop the water flow. Make sure the hose is secured over the drain and will not fall out of place causing unwanted water spillage.

2.1

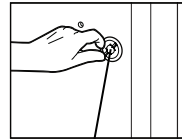

Drain Outlet

2.2

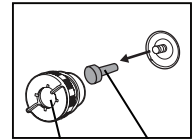

Drain Cap Rubber Stopper

2.3

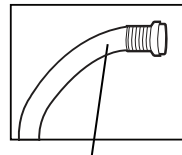

Garden Hose

2.4

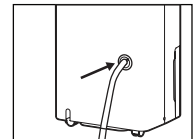

IMPORTANT: Make sure water can flow down the garden hose by keeping the hose angled down and free of bends or kinks.

IMPORTANT: If you stop using the continuous drain function, the drain cap and rubber stopper must be replaced before use to prevent leakage.

DRAINING THE WATER (CONTINUED)

THIS IS ONLY FOR MODELS WITH BUILT-IN DRAIN PUMP

DH45PWKN / DH45PWGN / DH50PW / DH70PW / DH70PWKN / DH70PWGN

3. Continuous Water Drainage – Using the Drain Pump Option (Drain Tube included)

The Continuous Drain Pump is available if you want to use the continuous drain function, but the drain is further away, or located above the dehumidifier. A 16.4ft (5m) long drain tube* can be attached to the continuous drain pump located on the back side of the dehumidifier. When the water level in the water tank reaches a certain level, the drain pump will automatically pump the water out of the tank to the drain. This allows you to drain water condensation vertically or horizontally, even if the drain is located above the dehumidifier.

- 3.1 Unwrap the drain tube from the dehumidifier and locate the drain tube connector on one end of the drain tube.
- 3.2 Insert the drain tube connector into the drain pump hole located on the rear side of the dehumidifier.
- 3.3 Push the drain tube connector into the drain pump hole until you hear a “click” sound.
- 3.4 Place the other end of the drain tube into the sink or drain. The water can be pumped up to 16.4ft (5m) vertically or horizontally.

NOTE: DO NOT use an alternative drain tube that is longer than the one provided with the unit.

- 3.5 To disconnect the drain tube, press the release button above the drain pump hole while pulling the drain tube connector away from the drain pump hole.

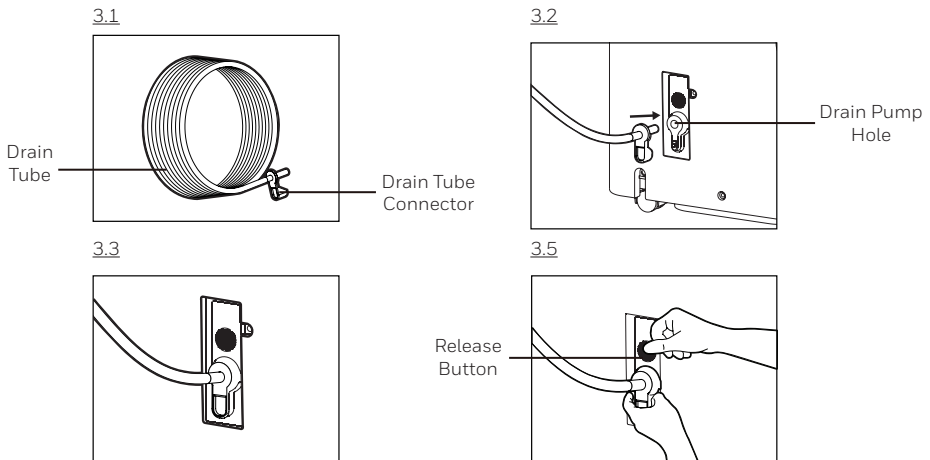

*Continuous Drain Tube is included in Dehumidifier models with Continuous Drain Pump feature only.

CLEANING & MAINTENANCE

WARNING: Always switch OFF the dehumidifier and unplug it from the electrical outlet before attempting any cleaning or maintenance of this product.

Appliance Maintenance:

- Switch OFF the appliance before disconnecting the power supply.
- Only use a soft cloth to clean the appliance.

Dust Filter Maintenance:

The Dust Filter located at the top of the unit helps to remove dust particles from the air. A dirty filter locked by dust particles can reduce the efficiency of the dehumidifier. For optimum dehumidification, it is recommended to clean the dust filter every 2 weeks:

1. Switch OFF the dehumidifier. Press down on the dust filter with 2 hands to release the dust filter from the top of the unit.
2. Rinse the dust filter under running water, or vacuum away the dust with a vacuum cleaner.
3. After cleaning the dust filter, dry in a cool, shaded place, then carefully reinstall into the unit.

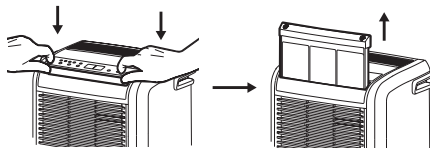

End of Season Storage & Maintenance:

If the appliance will not be used for an extended period of time:

- Switch OFF the unit and unplug from the electrical power outlet.
- Empty the water tank and let it dry. If your dehumidifier is connected to the continuous drain hose, you must disconnect the hose, dry and then replace the drain cap and rubber stopper back into the drain outlet.
- Remove the air filter and clean with water. Let the air filter dry and reinstall back into the unit.
- Make sure all parts of the dehumidifier and accessories are dry before storage.
- Cover the dehumidifier with a cloth/ plastic bag before storage, to protect the surface from dust and scratches.
- It is recommended to coil the power cord and store it off the floor to ensure it is protected from bends and kinks.
- Store the unit upright in a dry location, away from direct sunlight.

AUTO RESTART FUNCTION



This unit is equipped with an Auto Restart feature. When there is a power outage, the dehumidifier will automatically resume its previous settings upon regaining power.

TROUBLESHOOTING GUIDE

The following troubleshooting guide addresses the most common problems. If problems persist, call customer service.

PROBLEM	POSSIBLE CAUSE	SOLUTION
Dehumidifier does not start	No electricity.	Check for power.
	The power cord is not properly plugged in.	Remove and reconnect the power cord.
	The safety switch activated on the electrical plug.	Reset the safety switch and wait for 3 minutes to pass. Contact customer service if problem persists.
Unit runs but the humidity level does not decrease	The humidity level setting is too high.	Decrease the humidity level setting.
	A door or window is open, letting in new moisture.	Make sure all windows or doors to the outside are closed and tightly sealed.
	There are other sources of humidity in the room (e.g. boiling water in pot).	Switch on the dehumidifier when these sources are not present.
	The temperature in the room is too low.	The dehumidifier is designed to operate between 41°F (5°C) and 89°F (32°C). Moisture removal is greatly reduced if room temperatures exceed this temperature range.
	The dust filter is dirty/ blocked.	Clean the dust filter.
Air outlet or intake is blocked.	Remove blockage.	

TROUBLESHOOTING GUIDE (CONTINUED)

PROBLEM	POSSIBLE CAUSE	SOLUTION
Dehumidifier runs constantly/ does not stop	Area to be dehumidified is too large.	The capacity of your dehumidifier may not be adequate for the room it is used in. It is recommended to add an extra dehumidifier for large areas.
	A door or window is open, letting in new moisture.	Make sure all windows or doors to the outside are closed and tightly sealed.
Water Tank Full  is illuminated and the unit is beeping	The water tank is full.	Empty the water tank.
	The water tank is not in the correct position.	Position the water tank correctly into the unit. Unit will not operate until the water tank is secure in place.
The unit is blowing cold air out of the top vent	The purpose of the top air vent is to distribute air into the room.	The temperature of the air from the vent depends on the room environment and other factors. It can fluctuate and this is normal. No action required.
Defrost  is illuminated	The temperature of the room is too low.	The dehumidifier may not work effectively in low temperature environments. Increase the temperature of the room or wait until the temperature increases to use the dehumidifier.
Frost appears on the coils	Dehumidifier has been recently turned on in low room temperatures (usually below 41°F (5°C)).	This is normal. Frost will disappear in an hour or so after the dehumidifier is switched OFF.
Connected the continuous drain but the water condensation is not draining out the tube	Some floors may have an uneven surface which may affect the continuous drainage function	Raise the front of the Dehumidifier ½ to 1 inch (1.27 cm to 2.54 cm) from the floor. The water condensation will drain out the back hose and not into the bucket.

TROUBLESHOOTING GUIDE (CONTINUED)

PROBLEM	POSSIBLE CAUSE	SOLUTION
Water on the floor	The garden hose/ drain hose may be loose.	Check the connections between the hose and the drain outlet on the unit. See Continuous Water Drainage section.
	You intended to use the water tank to collect water but the continuous drain hose is still connected.	Disconnect the hose and replace the rubber stopper and drain cap if using the water tank to collect water. See Continuous Water Drainage section.
Noise	Fan is working.	Wind from the fan can create sounds during operation. This is a normal sound.

ERROR CODE GUIDE

ERROR CODE	POSSIBLE CAUSE	DESCRIPTION
"30"	Humidity Sensor Failure (Below 30%RH)	<p>If "30" appears, it means the room's relative humidity exceeds the lowest 30%RH level and the unit will pause operation. You can switch the unit ON again when the relative humidity reaches a level above 30% for 2 hours or more.</p> <p>If the "30" appears again, please contact the Customer Service Center.</p>
"90"	Humidity Sensor Failure (over 90%RH)	<p>If "90" appears, it means the room's relative humidity exceeds the highest 90%RH level and the unit will pause operation. You can switch the unit ON again when the relative humidity reaches a level below 90% for 2 hours or more.</p> <p>If the "90" appears again, please contact the Customer Service Center.</p>
"Lo"	Temperature Sensor Failure (below 32°F / 0°C)	<p>If "Lo" appears, it means the ambient room temperature is too cold, below 32°F (0°C) and so operation will be paused. You can switch ON the unit again when the ambient temperature warms up to 41°F (5°C) or higher for 2 hours or more.</p> <p>If "Lo" appears again, please contact the Customer Service Center.</p>
"Hi"	Temperature Sensor Failure (over 122°F / 50°C)	<p>If "Hi" appears, it means the ambient room temperature is too hot, or above 122°F (50°C) and so operation will be paused. Move the unit away from any heat source that may be causing this hot temperature. You can switch ON the unit again when the ambient temperature cools down to 89°F (32°C) or lower for 2 hours or more.</p> <p>If "Hi" appears again, please contact the Customer Service Center.</p>



Electrical products should be properly disposed of.
 Please recycle where facilities exist.
 Check with your local authority or retailer for recycling.

JMATEK North America LLC
Mahwah, New Jersey 07495 USA
Email: usinfo@jmatek.com
Web: www.jmatek.com

Made in China
© 2021 JMATEK Limited. All rights reserved.
The Honeywell Trademark is used under license
from Honeywell International Inc.
Honeywell International Inc. makes no
representations or warranties with respect to this product.
This product is manufactured by Airtex Int'l Corp. Ltd.
(subsidiary of JMATEK Ltd.).

Honeywell